

## **BLUE FASTENER**

ATTACH w/ 1/4"-16 x 1 1/4"  
SELF-DRILLING FASTENER THROUGH  
FOAM & CORE @ 2'-0" O.C.  
TO 1 1/2" X 1 1/2" X 16 GAUGE  
SHIPLAP ANGLE BY KORETECK

EPS FILLER BY  
COATING CONTRACTOR  
IF NECESSARY

TUBE (N.B.K.)

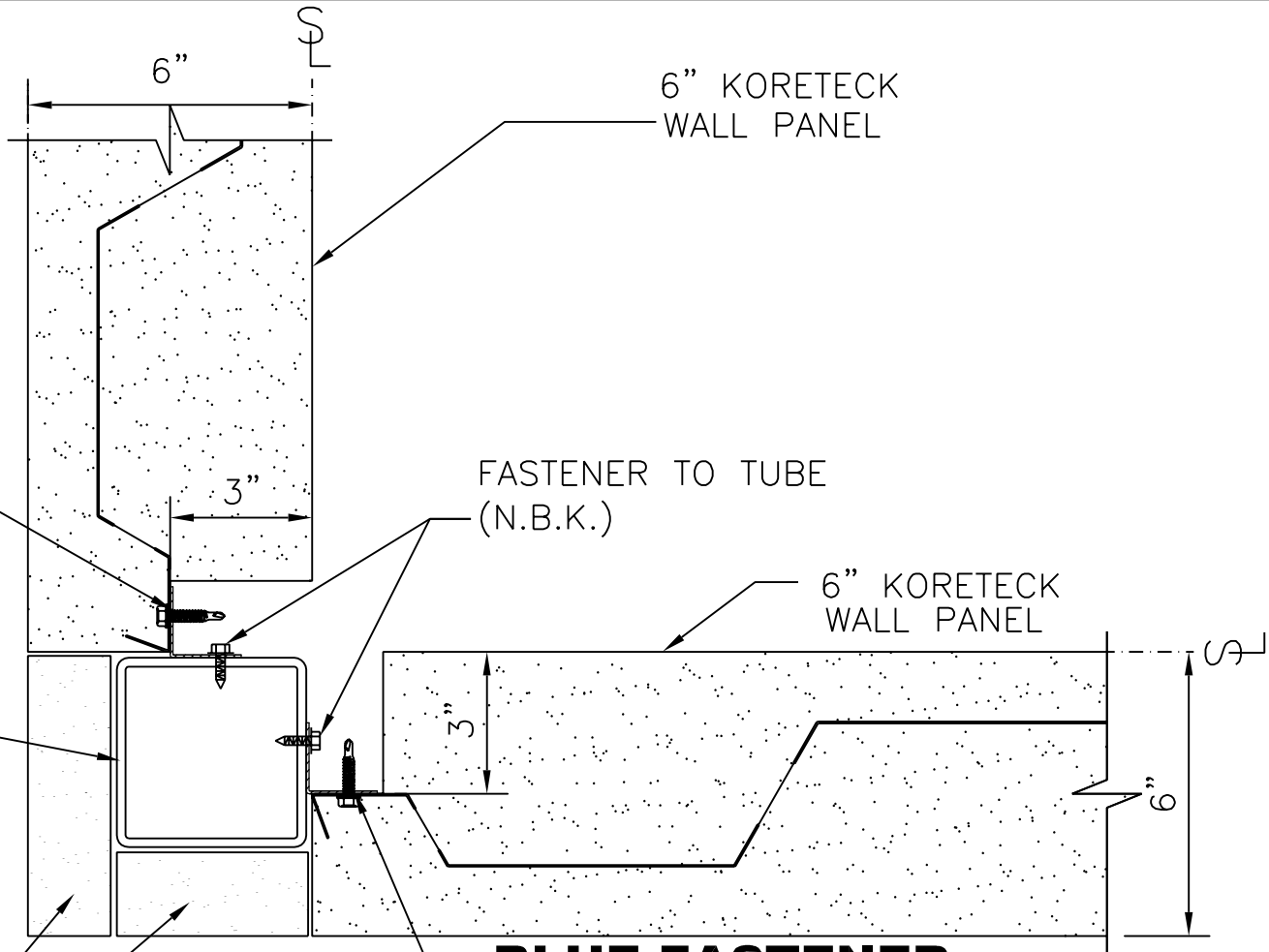

## **BLUE FASTENER**

ATTACH w/ 1/4"-16 x 1 1/4"  
SELF-DRILLING FASTENER THROUGH  
FOAM & CORE @ 2'-0" O.C.  
TO 1 1/2" X 1 1/2" X 16 GAUGE  
SHIPLAP ANGLE BY KORETECK